

Attachment Chain

Renold Jeffrey offers a wide array of attachment chains suitable for nearly any application. Our base chains feature the quality that you know and trust. Combine that with the speed and reliability of delivery and you have high-quality, maximum-value attachment chain.

Our National Service Center in Hebron, Kentucky, is designed to meet your attachment chain needs quickly and efficiently. We maintain substantial inventories of components to craft attachment chains in carbon steel as well as in our special Hydro-Service® coating. We also have a wide variety of stainless steel products available.

Whether you need an item from stock or made to order, we'll get you the information and the product you need.

Attachment Chain available in:

- Carbon Steel
- Hydro-Service®
- Stainless Steel
- Nickel-Plated
- Syno®
- and more

The choice is yours...



Quality
Reliability
Performance
Value

How to order Renold Jeffrey Attachment Chains

1. Specify chain number.
2. Determine type of attachment. (A-1, SK-1, etc.)
3. Specify attachment spacing. (every pitch, every 2nd, etc. Evenly spaced attachments are placed on pin links unless specified otherwise.)
4. Specify length of each strand. (number of pitches per strand)
5. Specify how many strands.



A-1



K-1

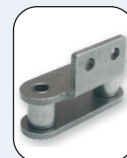

A-2



K-2



SA-1

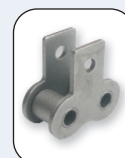

SK-1



SA-2



SK-2



D-1

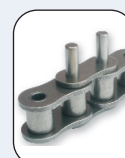

D-3



WA-1



WK-1



WA-2



WK-2



WSA-1



WSK-1



WSA-2



WSK-2